

CRASHBOX

ENARD LAURIANNE - ROMEO MELANIE

U N T U B E E T U N R E C E P T A C L E

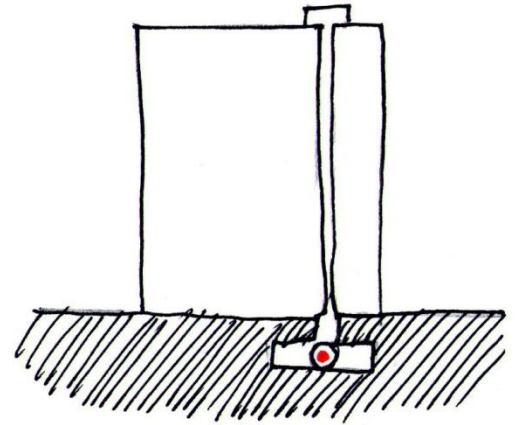

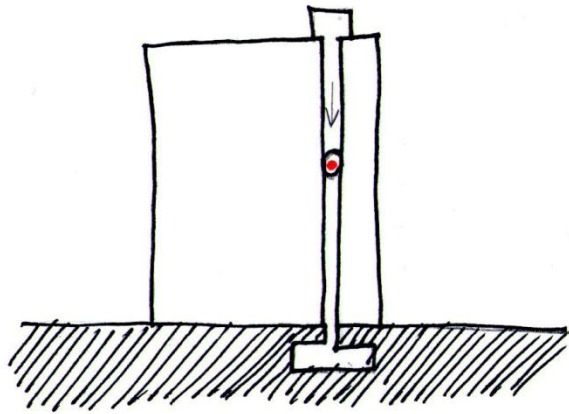
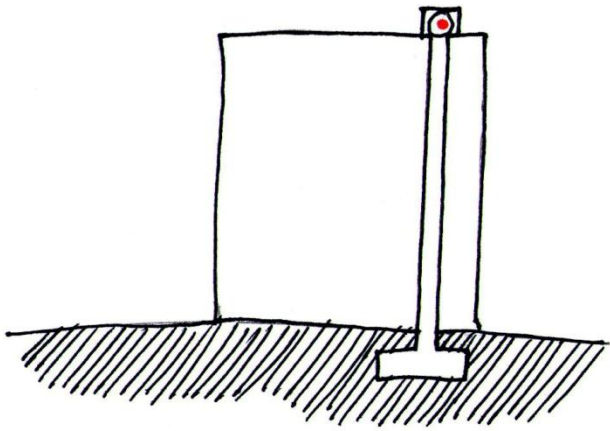
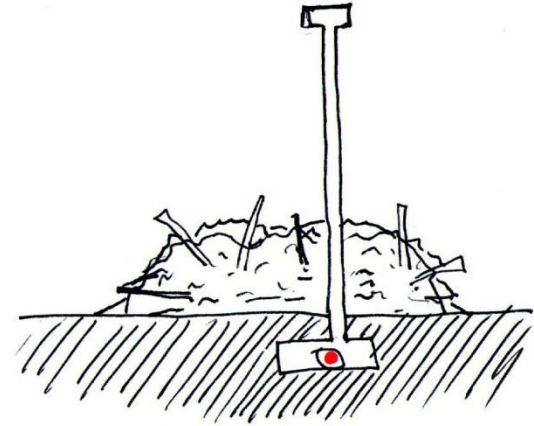
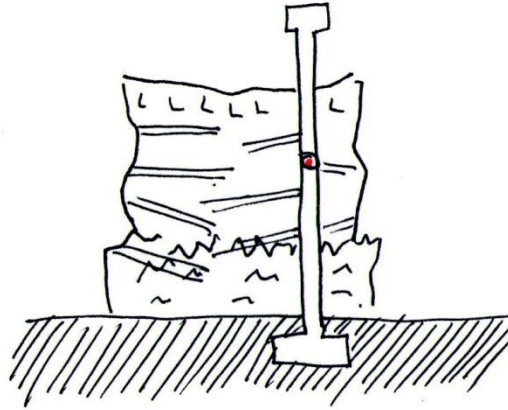
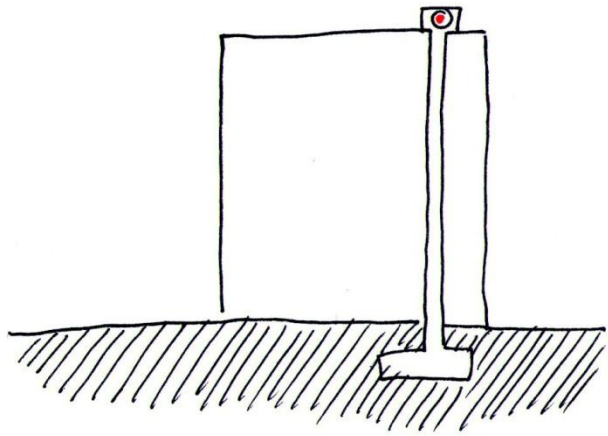

Q U E S E P A S S E - T - I L D A N S L E T U B E ?

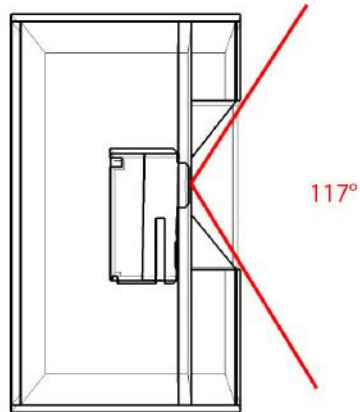
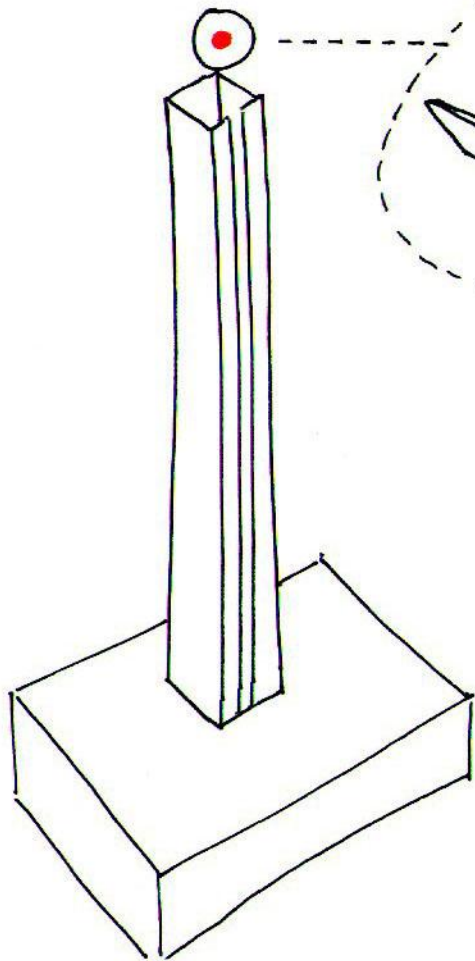
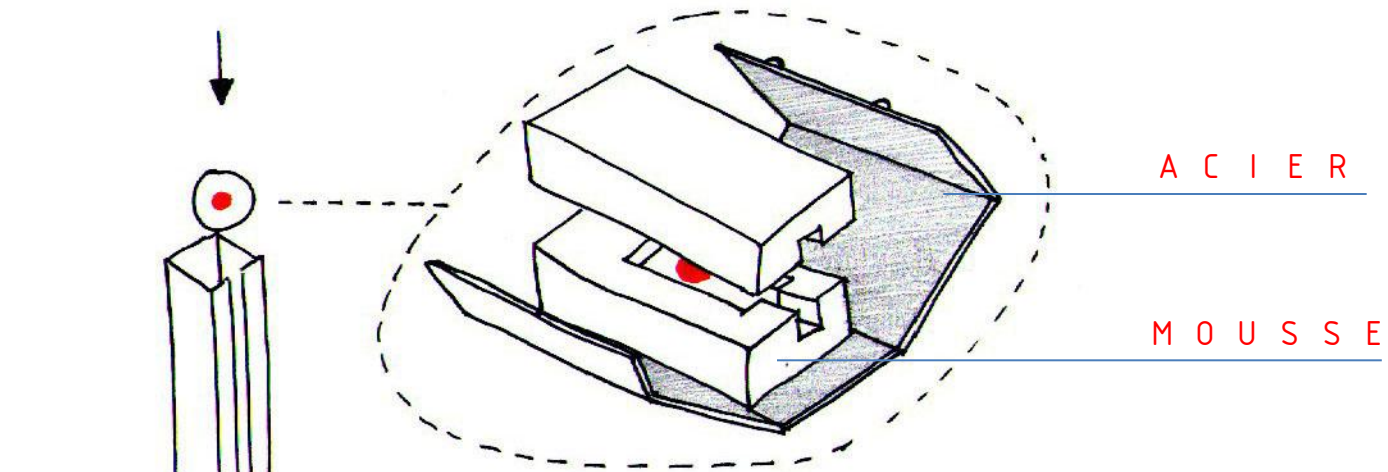

VUE DU DESSUS

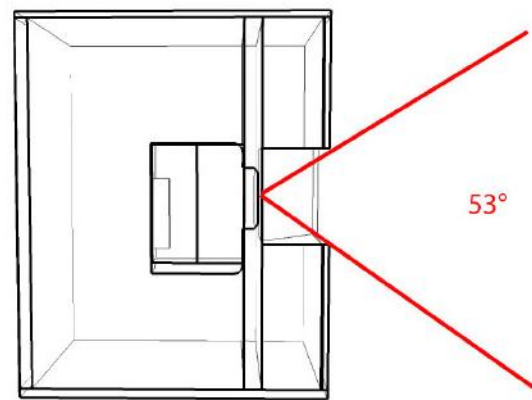

VUE DE COTE

COMMENT LA CRASHBOX PEUT-ELLE ATTEINDRE LE
RECEPTACLE AVANT LA DEMOLITION DU TUBE ?

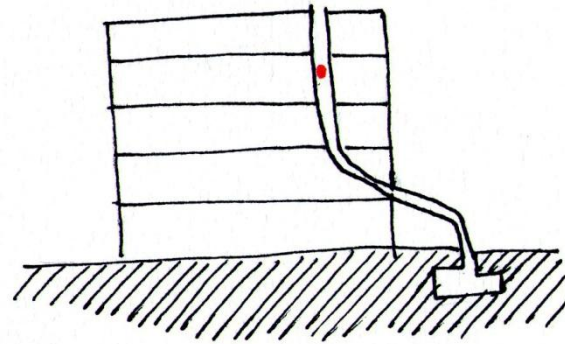
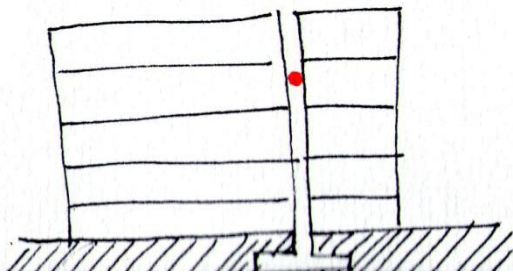

DEVIER LE TUBE VERS L'EXTERIEUR?

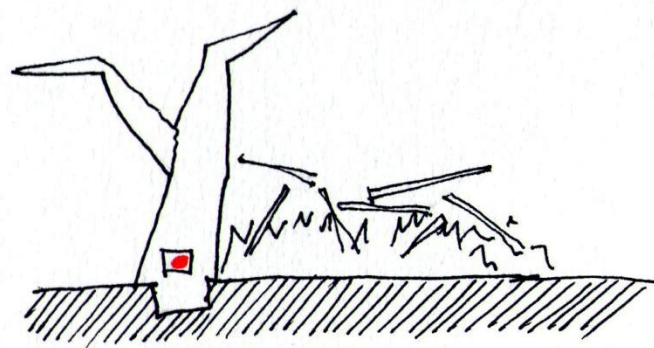
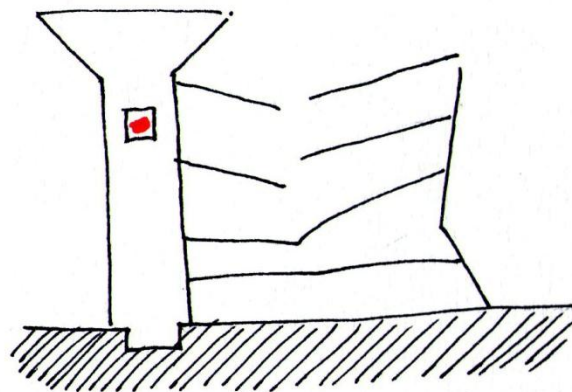
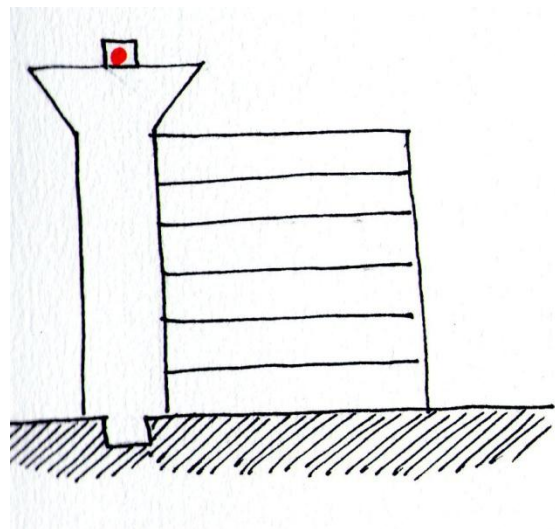

SUPPRIMER LE TUBE POUR UNE CHUTE LIBRE DANS
LE RESERVOIR D'EAU?

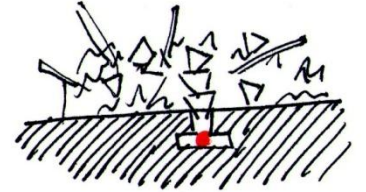
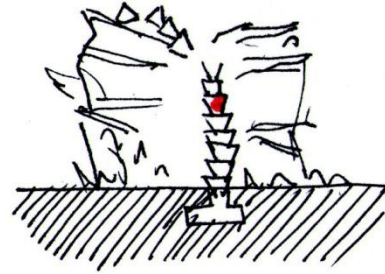
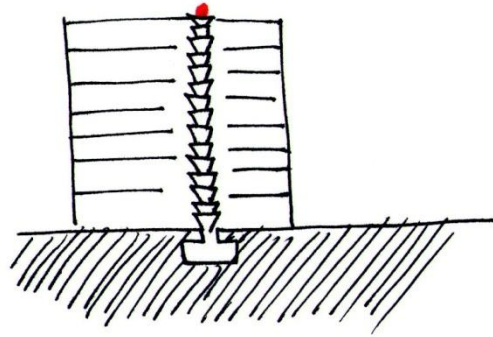
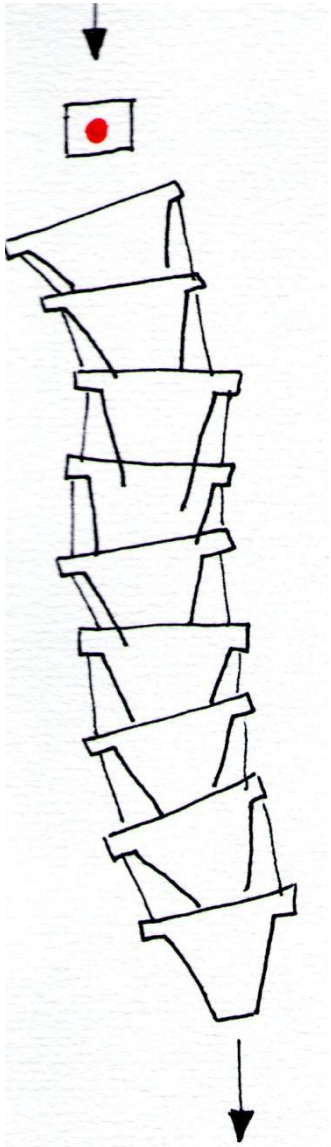

UTILISER UN TUBE QUI EVACUE LES GRAVATS DE CHANTIER?

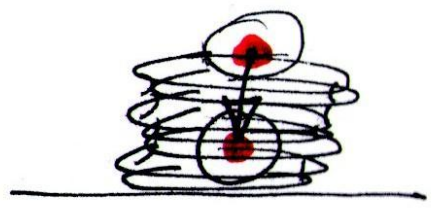
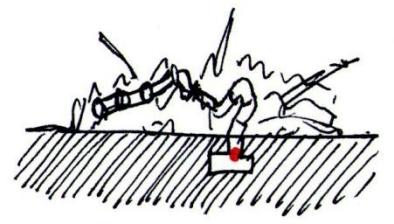
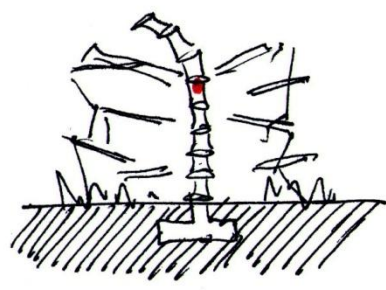
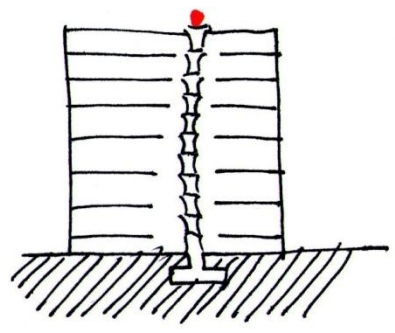
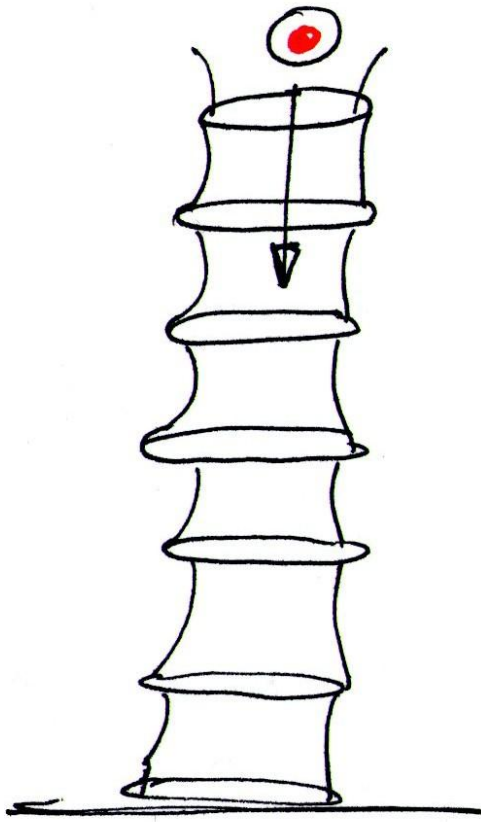

UTILISER UN TUBE QUI SE REPLIE SUR LUI MEME ?

ET SI ON INVERSE LE SYSTEME ?

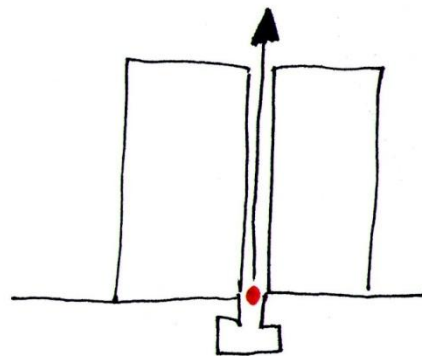

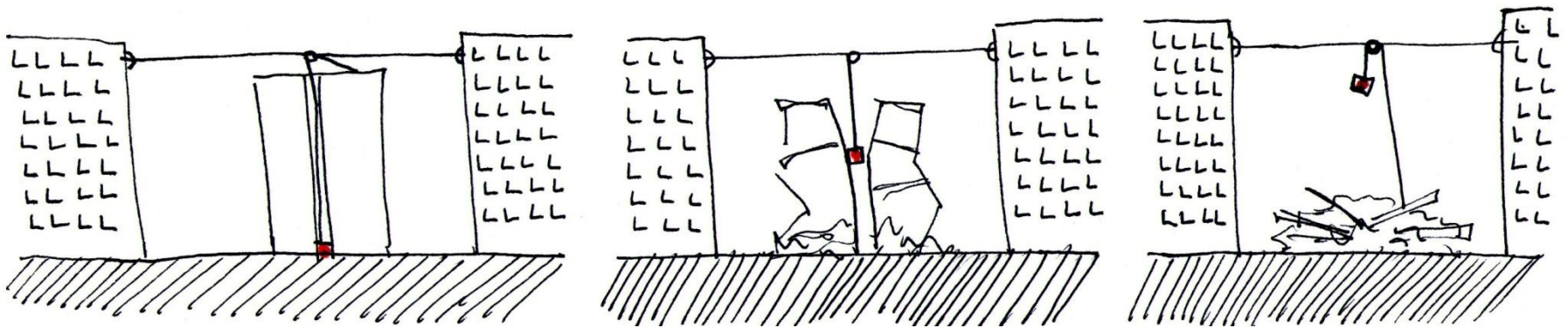

SE GREFFER AUX BATIMENTS VOISINS ?

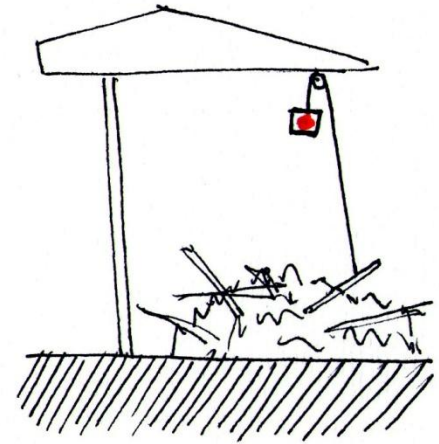
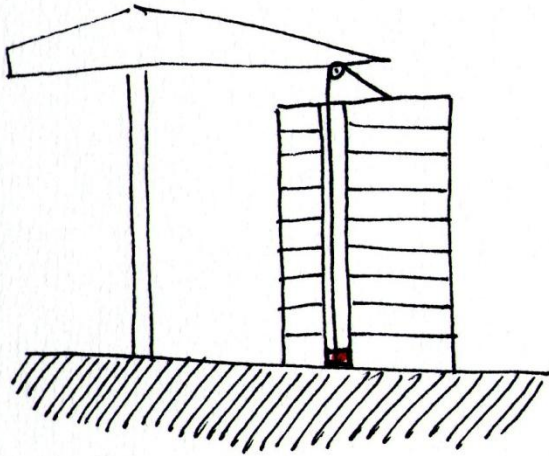

UTILISER UNE GRUE POUR RECUPERER LA
CRASHBOX?

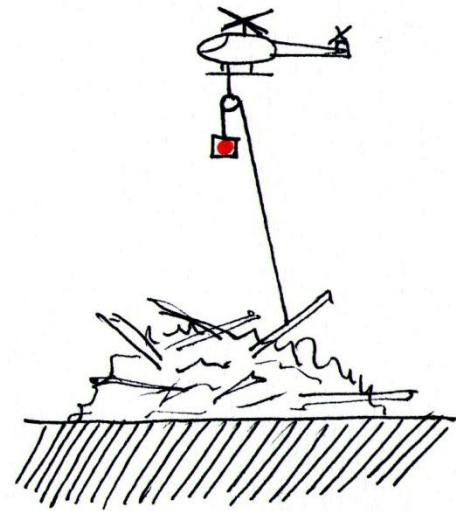
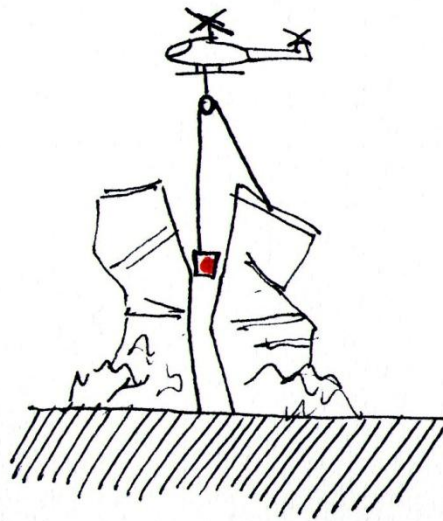
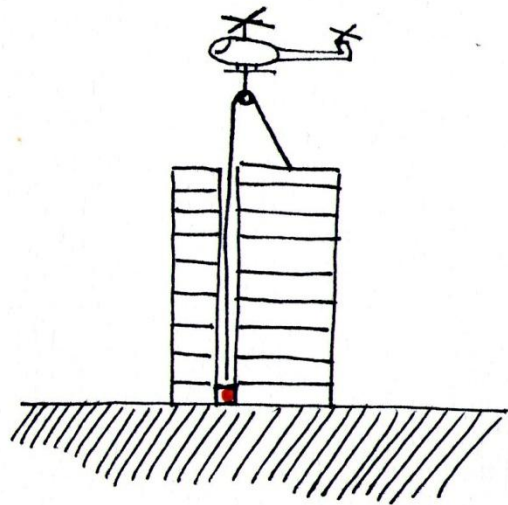

AVEC L'AIDE D'UN HELICOPTERE ?

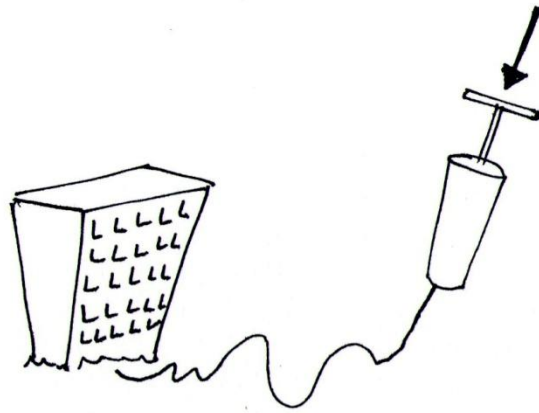

UTILISER DE L'AIR COMPRIME POUR FAIRE UN
CANON A CRASHBOX?

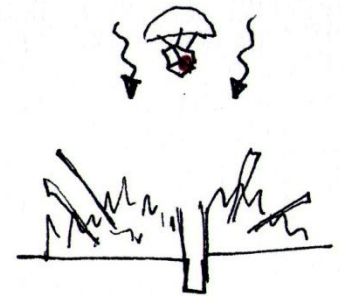
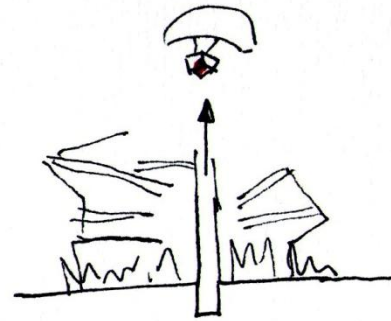
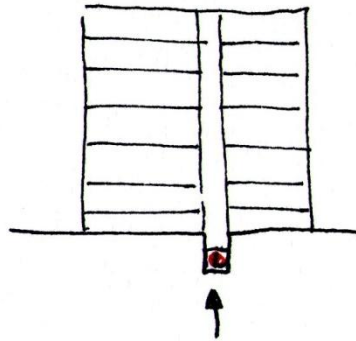
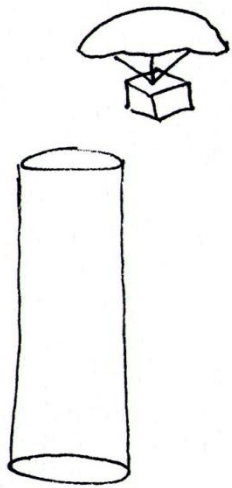

UTILISER UN PARACHUTE ?

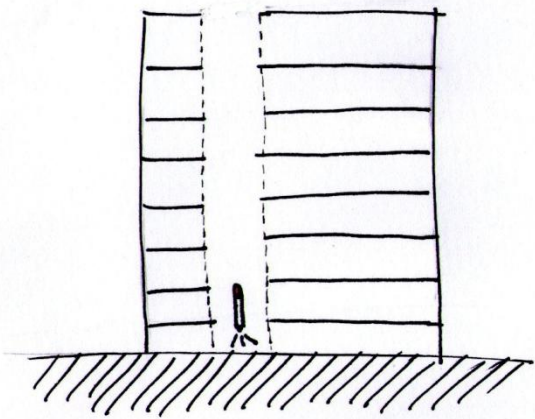

ON PROPULSE
LA CRASHBOX

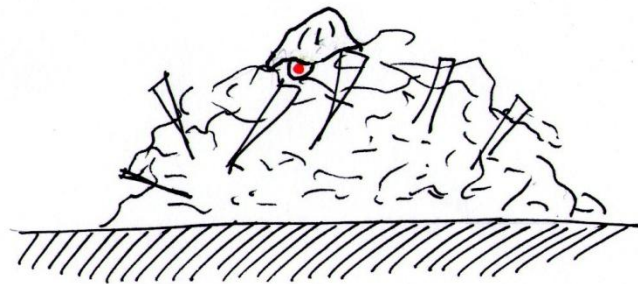
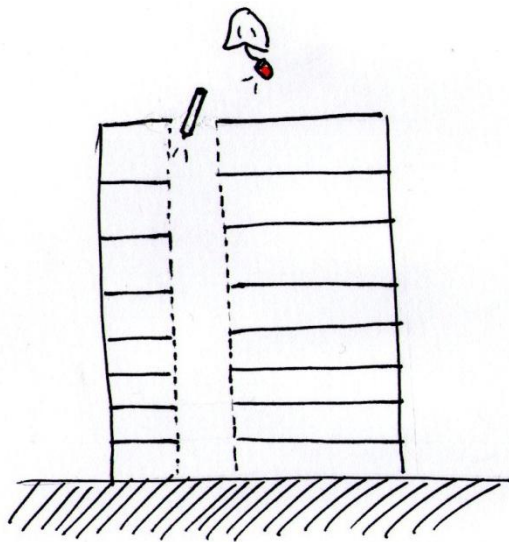

ON RETROUVE
LA CRASHBOX

PAR UN SYSTÈME
D'AIR COMPRIMÉ

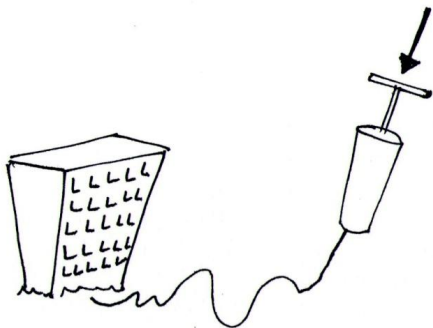

COULEUR DU PARACHUTE



COULEUR PHOSPHORESCENTE
COULEUR FLUORESCENTE
COULEUR VIVE

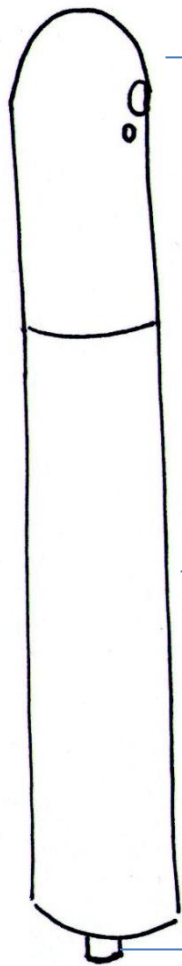

C A M E R A

R E S E R V O I R A A I R

V A L V E



D E C L E N C H E M E N T

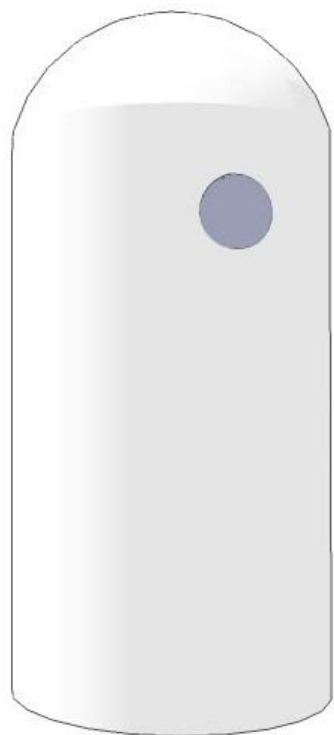

COQUE EN ACIER

GOPRO

MOUSSE

PARACHUTE

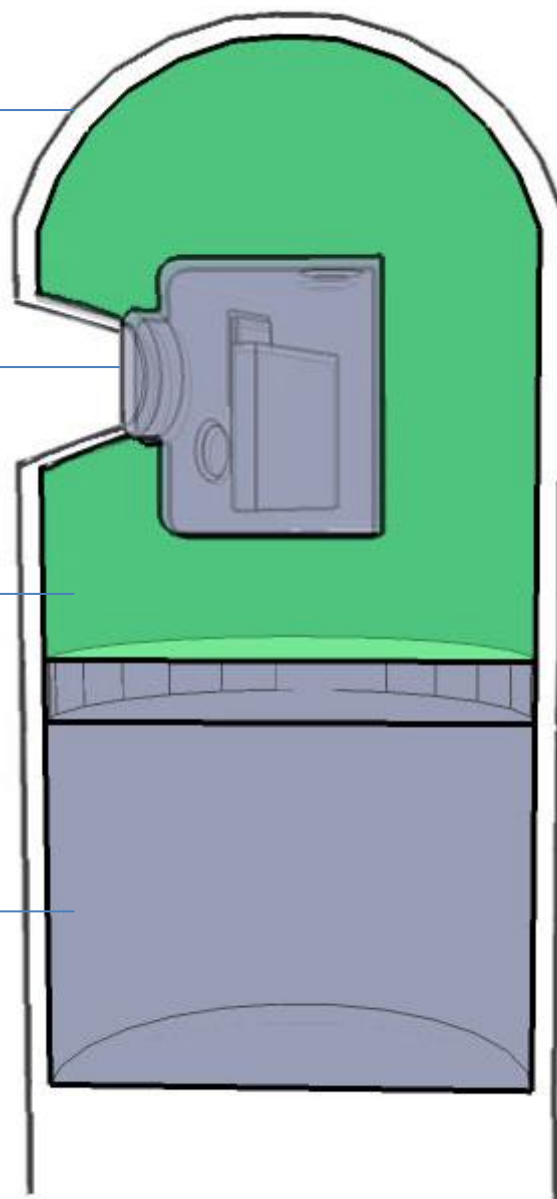

14 cm

17 cm

8 cm

10 cm